

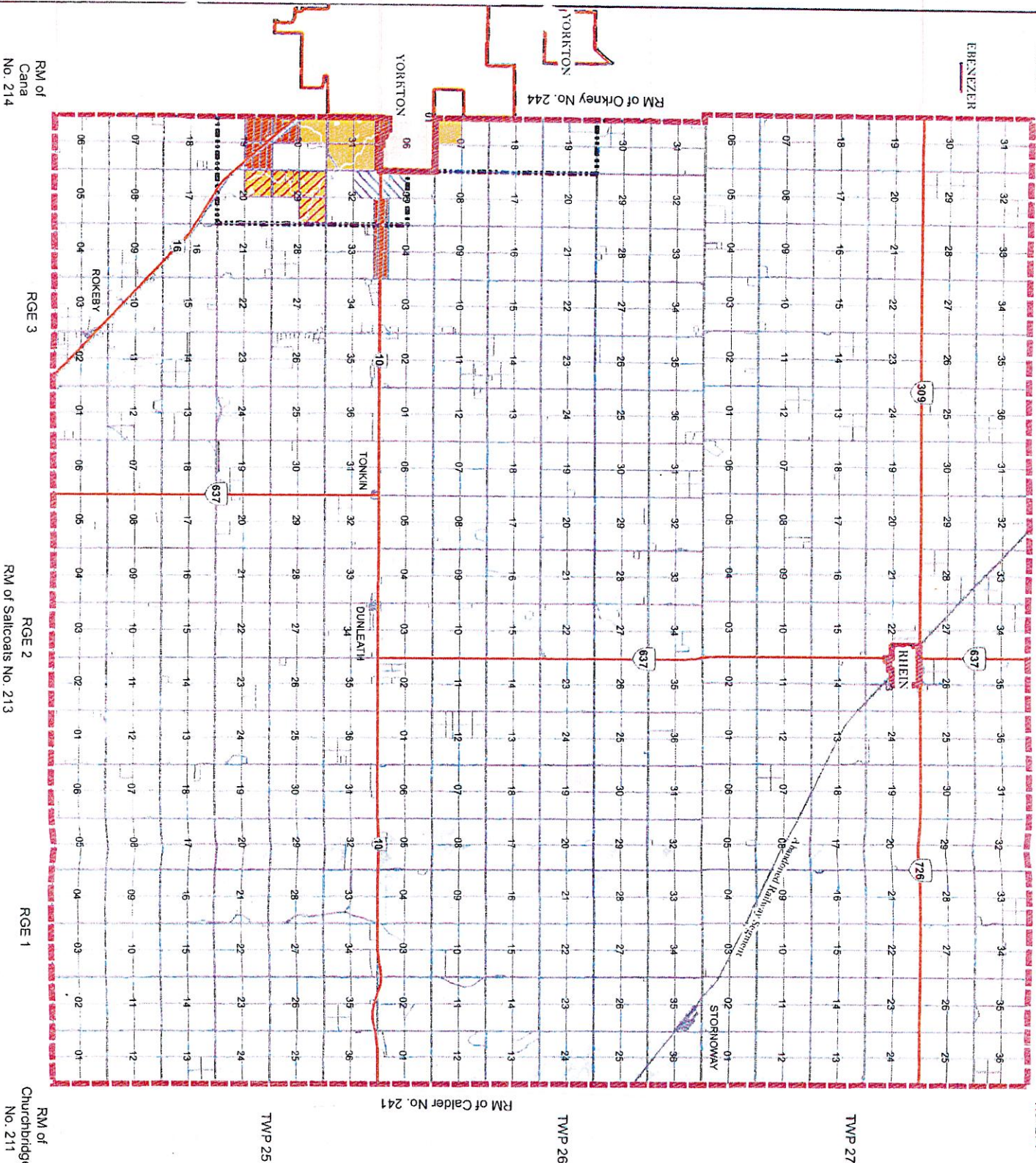











RM of Good Lake No. 274  
 RM of Sliding Hills No. 273  
 RM of Cole No. 271



**RURAL MUNICIPALITY OF WALLACE No. 243**  
**SASKATCHEWAN**

-  Future Commercial Development
-  Future Industrial Development
-  Future Residential Development
-  RM Future Commercial/Industrial
-  RM Future Residential
-  RM Future Commercial/Industrial - Limited Services
-  Future Study Area - First Nations Lands







-  Railways
-  Major Highways
-  Watercourse
-  Waterbody
-  Joint Management Area
-  Urban Municipality
-  RM Boundary

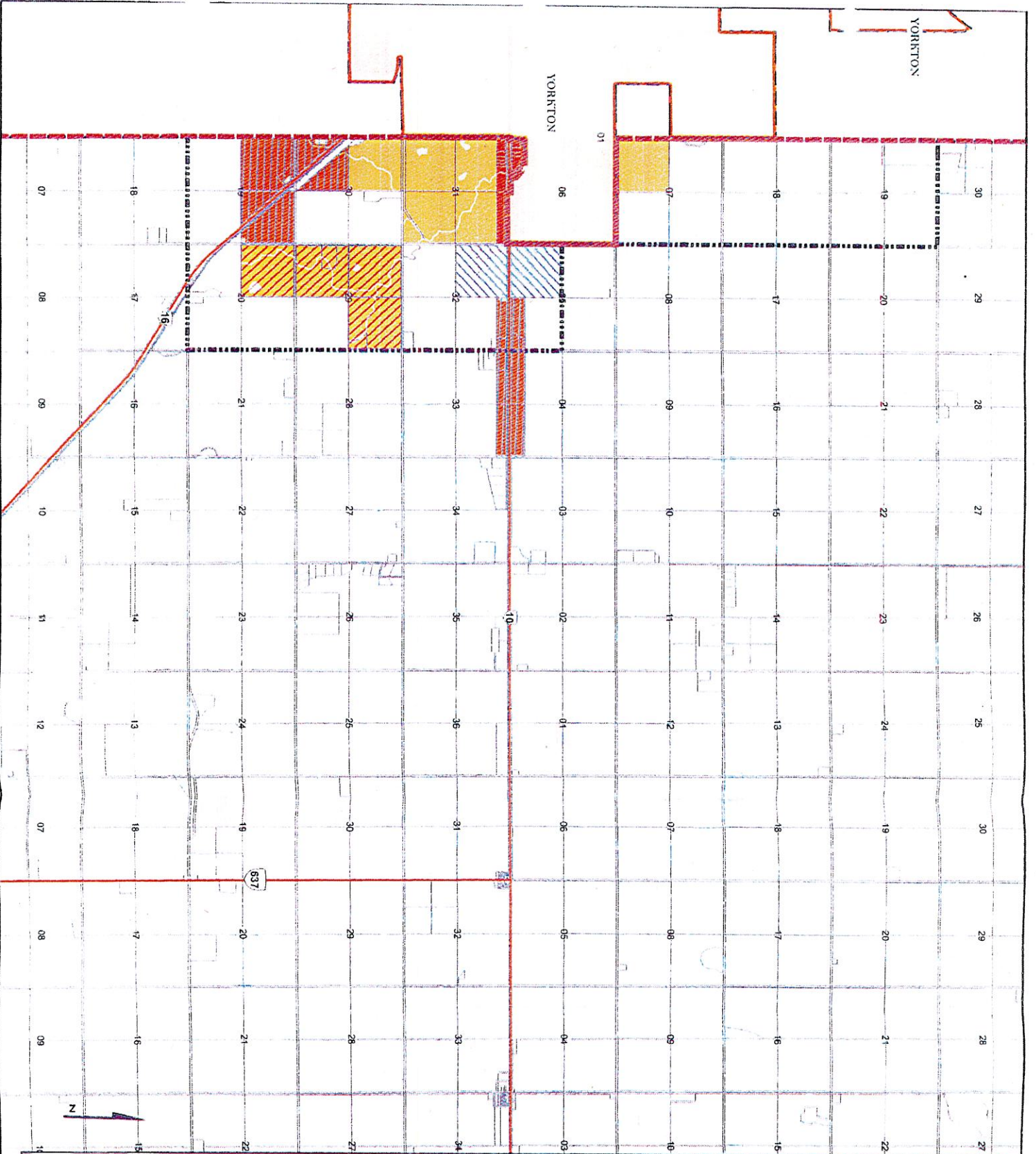





**Future Land Use Map**



**RURAL MUNICIPALITY OF  
WALLACE No. 243  
SASKATCHEWAN**

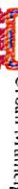

-  Future Commercial Development
-  Future Industrial Development
-  Future Residential Development
-  RM Future Commercial/Industrial
-  RM Future Residential
-  RM Future Commercial/Industrial - Limited Services
-  Future Study Area - First Nations Lands

-  Railways
-  Major Highways
-  Watercourse
-  Waterbody
-  Joint Management Area
-  Urban Municipality
-  RM Boundary

**Future Land Use Map  
City of Yorkton Area**

0 0.4250.85 1.7 Kilometers

TONKIN

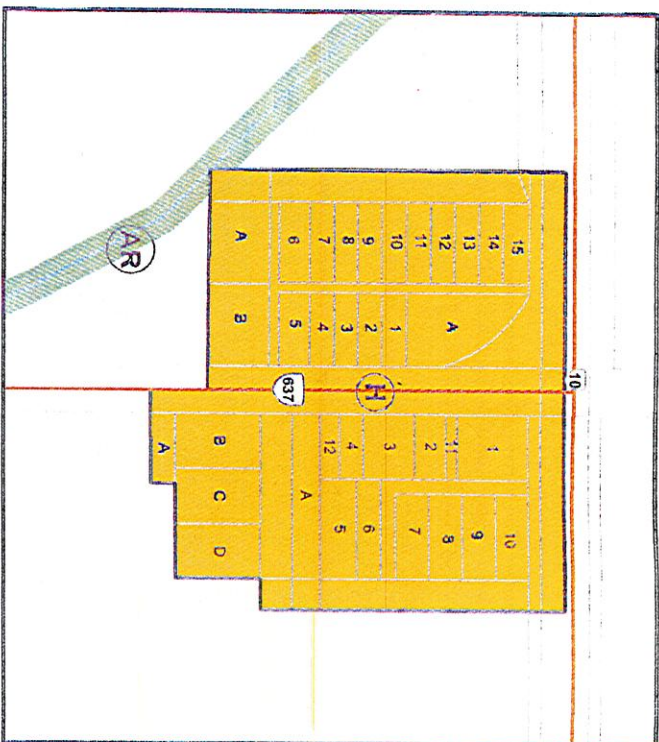

STORNOWAY

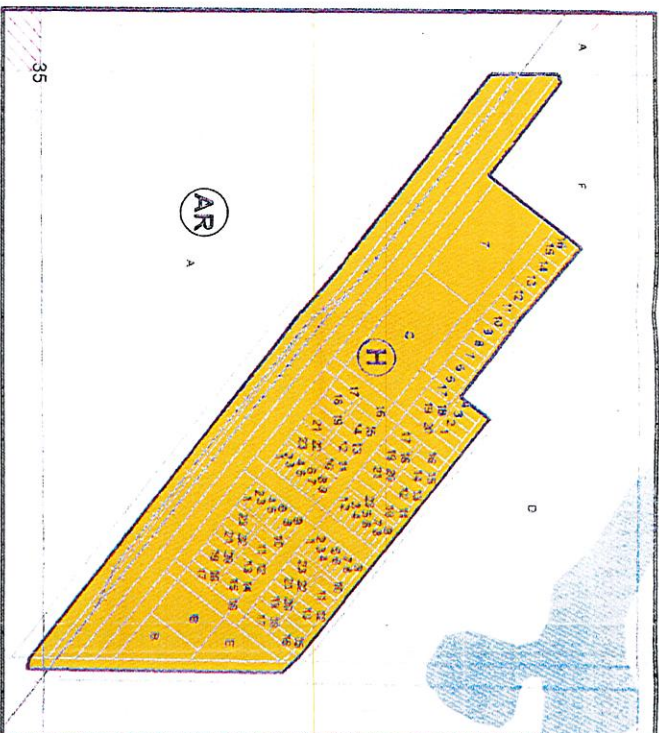

DUNLEATH

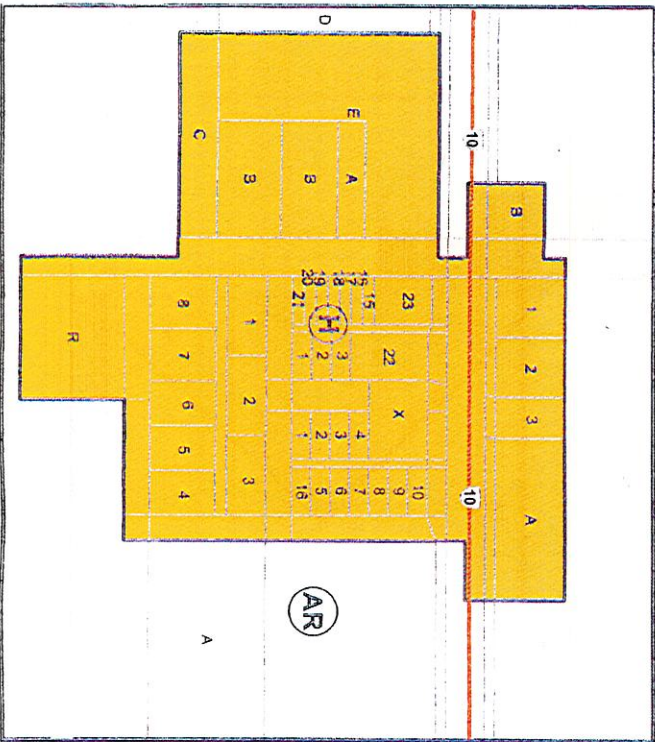

ROKEBY

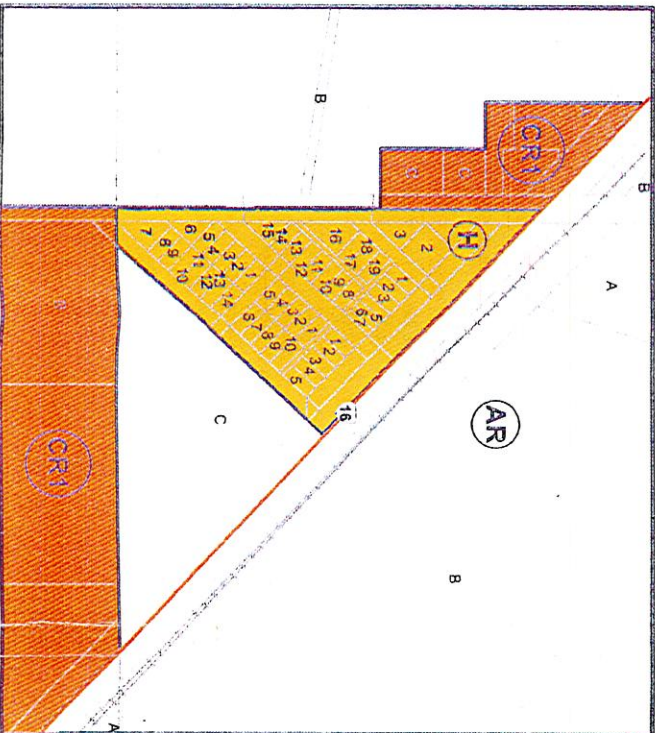

RURAL MUNICIPALITY OF WALLACE NO. 243

SASKATCHEWAN  
Zoning District Map  
Detail 5  
Hamlet Areas

THIS IS THE ZONING DISTRICT MAP  
REFERRED TO IN BYLAW NO. 103-2015  
ADOPTED BY THE RM OF WALLACE NO 243

REEVE

ADMINISTRATOR

APPROVED ON THE 14<sup>TH</sup> DAY OF August 2015

MINISTRY OF GOVERNMENT RELATIONS

Zoning Districts

- Agricultural/Resource - AR
- Country Residential - CR1
- Lakeshore Residential - LS
- Hamlet / Hamlet Areas - H
- High Profile Highway Commercial/Light Industrial - HPC
- Industrial - IND

Overlay Districts

- Environmentally Sensitive - ES
- Mineral Resource Extraction - MIRE
- Heritage Resource - HR (Requires Further Screening)
- Aquifer - A



RM of Good Lake  
No. 274

RM of Sliding Hills No. 273

RM of Cole  
No. 271

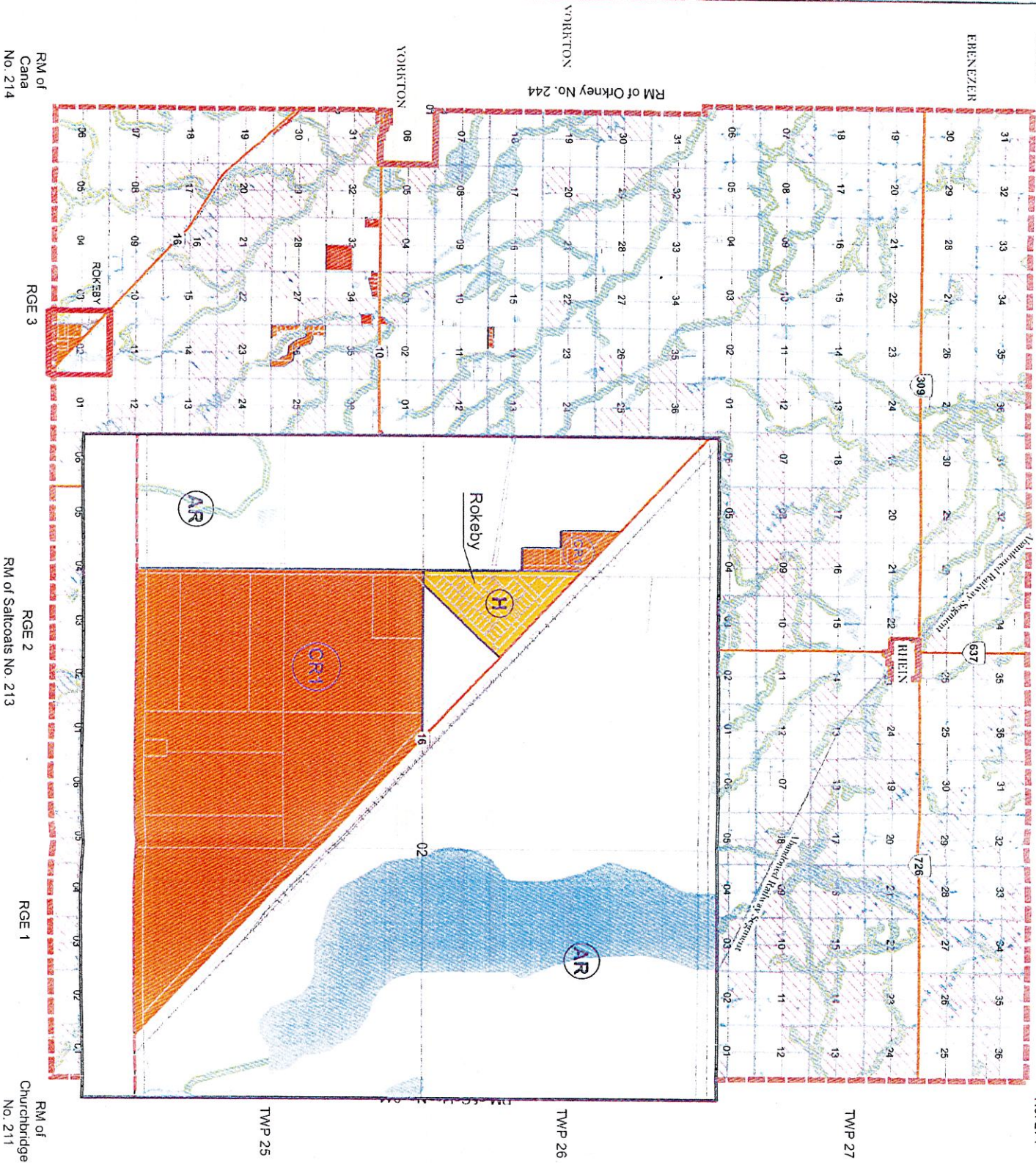

# RURAL MUNICIPALITY OF WALLACE NO. 243

SASKATCHEWAN

Zoning District Map  
Detail 4

THIS IS THE ZONING DISTRICT MAP  
REFERRED TO IN BYLAW NO. 103-2015  
ADOPTED BY THE RM OF WALLACE NO. 243

*W. Wallace*  
REEVE

ADMINISTRATOR

APPROVED ON THE 14<sup>TH</sup> DAY OF August, 2015

MINISTRY OF GOVERNMENT RELATIONS

### Zoning Districts

- Agricultural/Resource - AR
- Country Residential - CR1
- Lakeshore Residential - LS
- Hamlet / Hamlet Areas - H
- High Profile Highway Commercial/Light Industrial - HPC
- Industrial - IND

### Overlay Districts

- Environmentally Sensitive - ES
- Mineral Resource Extraction - MRE
- Heritage Resource - HR (Requires Further Screening)
- Aquifer - A



RM of Good Lake No. 274  
 RM of Sliding Hills No. 273  
 RM of Cole No. 271

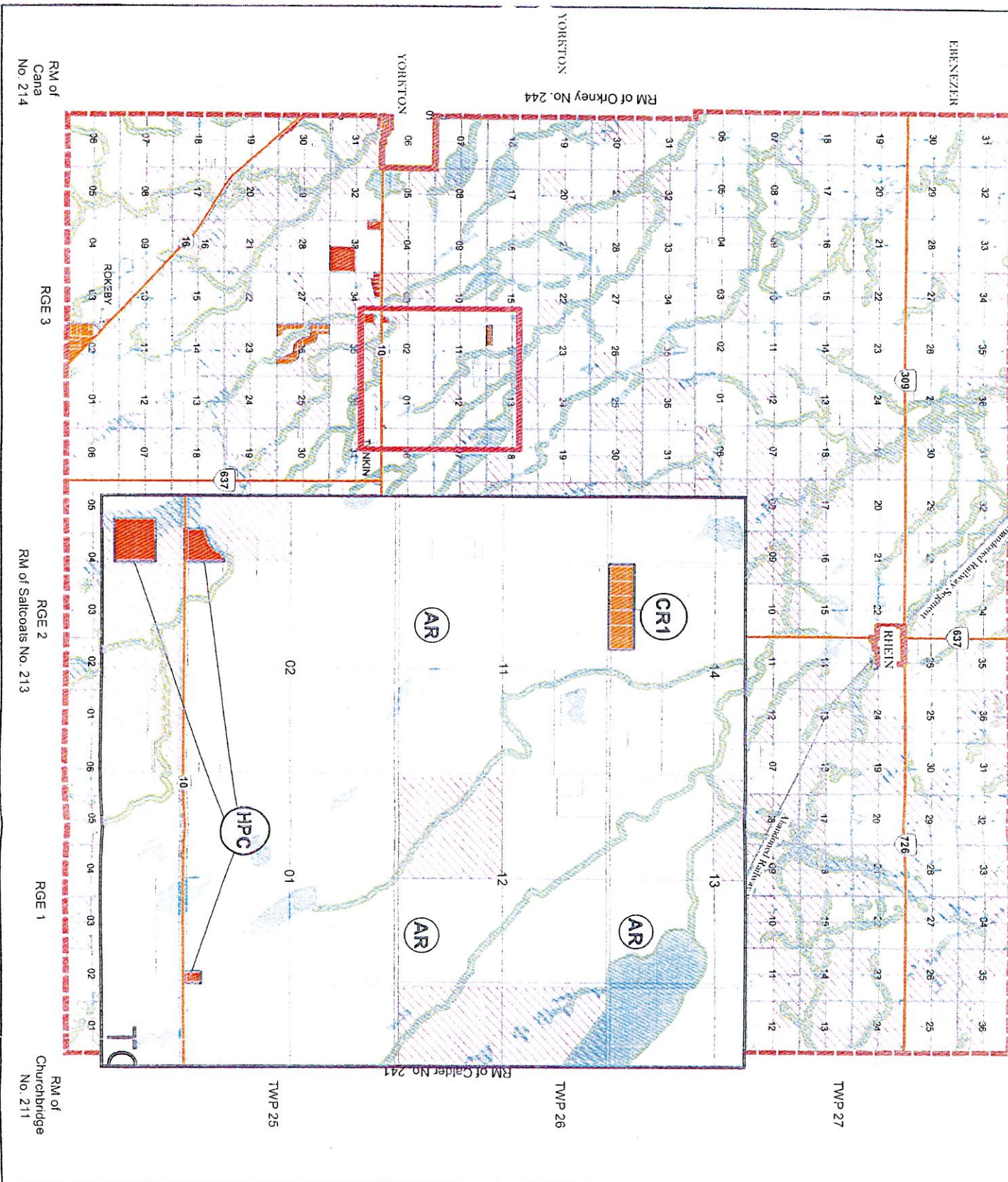

# RURAL MUNICIPALITY OF WALLACE NO. 243

SASKATCHEWAN

Zoning District Map  
 Detail 3

THIS IS THE ZONING DISTRICT MAP REFERRED TO IN BYLAW NO. 103-2015 ADOPTED BY THE RM OF WALLACE NO. 243

REEVE  
*[Signature]*

ADMINISTRATOR

APPROVED ON THE 14<sup>th</sup> DAY OF August, 2015

MINISTRY OF GOVERNMENT RELATIONS

### Zoning Districts

- Agricultural/Resource - AR
- Country Residential - CR1
- Lakeshore Residential - LS
- Hamlet / Hamlet Areas - H
- High Profile Highway Commercial / Light Industrial - HPC
- Industrial - IND

### Overlay Districts

- Environmentally Sensitive - ES
- Mineral Resource Extraction - MIRE
- Heritage Resource - HR (Requires Further Screening)
- Aquifer - A



RM of Good Lake No. 274  
 RM of Sliding Hills No. 273  
 RM of Cole No. 271

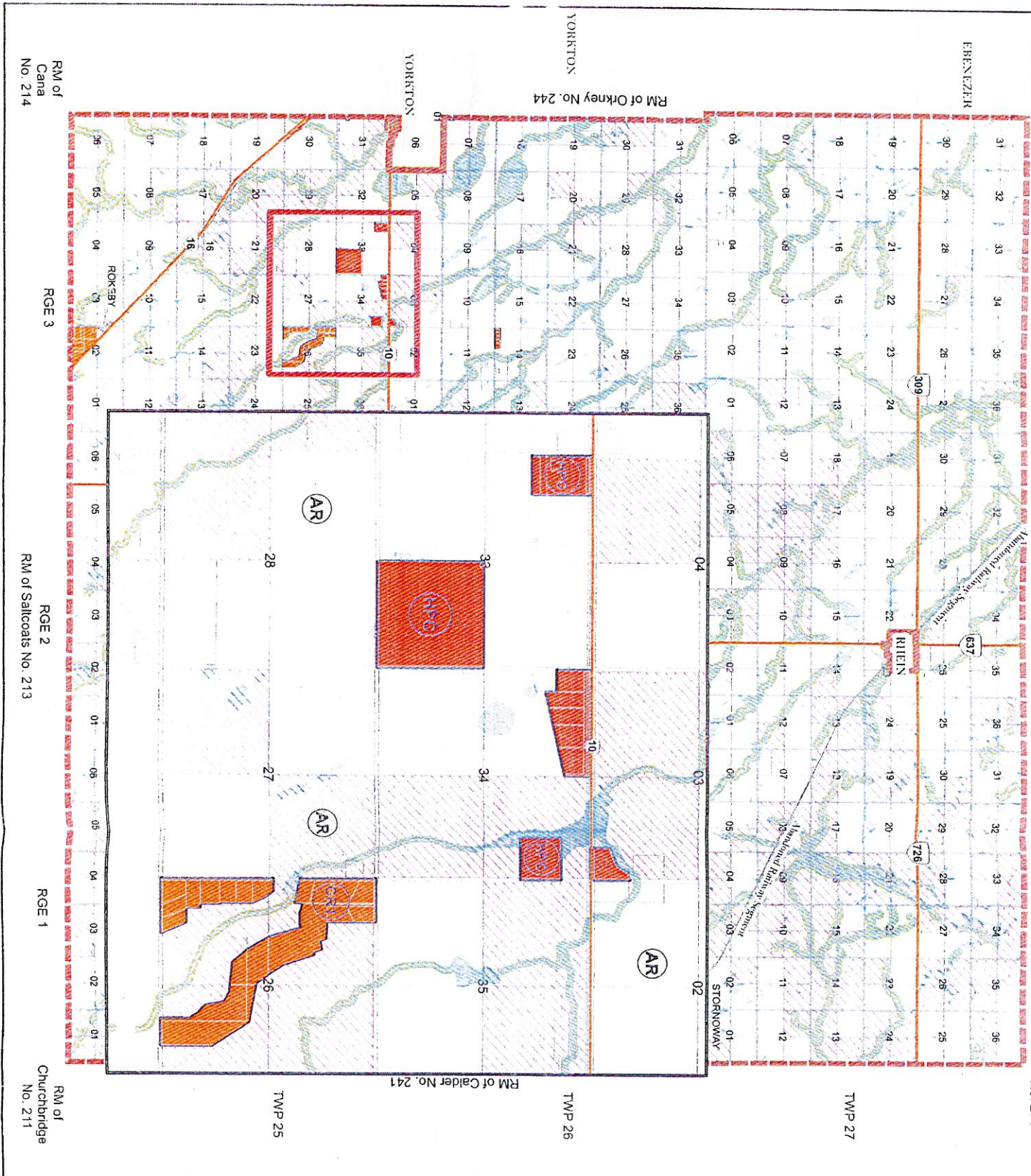

# RURAL MUNICIPALITY OF WALLACE NO. 243

SASKATCHEWAN

Zoning District Map  
 Detail 2

THIS IS THE ZONING DISTRICT MAP REFERRED TO IN BY-LAW NO. 103-2015 ADOPTED BY THE RM OF WALLACE NO. 243

*[Signature]*  
 REEF  
 ADMINISTRATOR

APPROVED ON THE 14<sup>th</sup> DAY OF August, 2015

MINISTRY OF GOVERNMENT RELATIONS

### Zoning Districts

- Agricultural/Resource - AR
- Country Residential - CR1
- Lakeshore Residential - LS
- Hamlet / Hamlet Areas - H
- High Profile Highway Commercial/Light Industrial - HPC
- Industrial - I/ND

### Overlay Districts

- Environmentally Sensitive - ES
- Mineral Resource Extraction - MRE
- Heritage Resource - HR (Requires Further Screening)
- Aquifer - A

RM of Good Lake  
No. 274

RM of Sliding Hills No. 273

RM of Cole  
No. 271

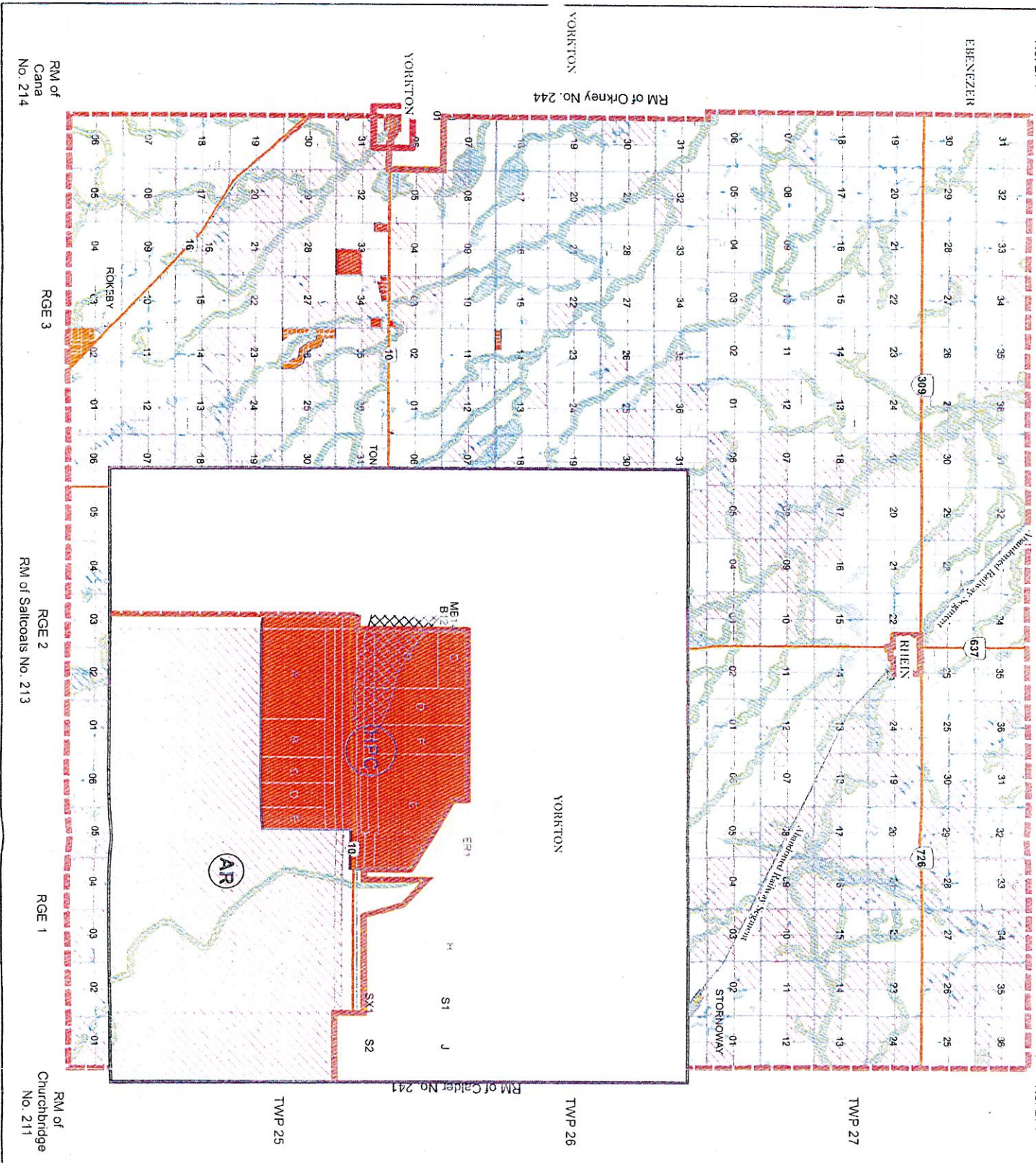

**RURAL MUNICIPALITY OF WALLACE NO. 243**

**SASKATCHEWAN**

**Zoning District Map  
Detail 1**

THIS IS THE ZONING DISTRICT MAP REFERRED TO IN BYLAW NO. 103-2015 ADOPTED BY THE RM OF WALLACE NO. 243

REEVE  
ADMINISTRATOR

APPROVED ON THE 14<sup>TH</sup> DAY OF August, 2015

MINISTRY OF GOVERNMENT RELATIONS

**Zoning Districts**

- Agricultural/Resource - AR
- Country Residential - CRI
- Lakeshore Residential - LS
- Hamlet / Hamlet Areas - H
- High Profile Highway Commercial/Light Industrial - HPC
- Industrial - IND

**Overlay Districts**

- Environmentally Sensitive - ES
- Mineral Resource Extraction - MRE
- Heritage Resource - HR (Requires Further Screening)
- Aquifer - A



RM of Good Lake  
No. 274

RM of Sliding Hills No. 273

RM of Cole  
No. 271

EBENEZER

YORKTON

RM of Orkney No. 244

YORKTON

RM of  
Cana  
No. 214

RGE 3

RGE 2  
RM of Saltcoats No. 213

RGE 1

RM of  
Churchridge  
No. 211

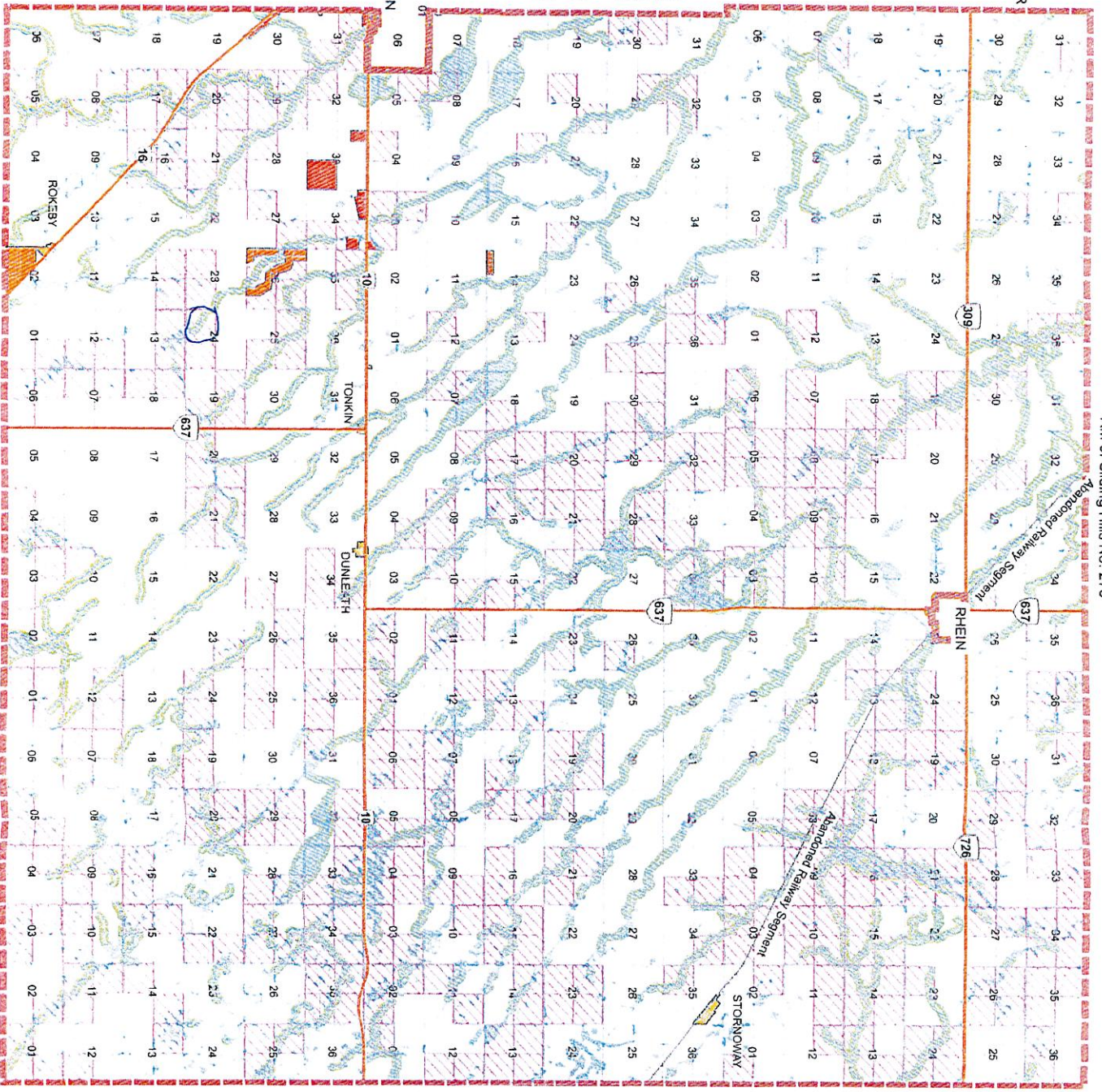

# RURAL MUNICIPALITY OF WALLACE NO. 243

SASKATCHEWAN

## Zoning District Map

THIS IS THE ZONING DISTRICT MAP REFERRED TO IN BYLAW NO. 103-2015 ADOPTED BY THE RM OF WALLACE NO. 243

*REEVE*  
ADMINISTRATOR

APPROVED ON THE 14<sup>TH</sup> DAY OF August, 2015

MINISTRY OF GOVERNMENT RELATIONS

### Zoning Districts

- Agricultural / Resource - AR
- Country Residential - CRI
- Lakeshore Residential - LS
- Hamlet / Hamlet Areas - H
- High Profile Highway Commercial / Light Industrial - HPC
- Industrial - IND

### Overlay Districts

- Environmentally Sensitive - ES
- Mineral Resource Extraction - MRE
- Heritage Resource - HR (Requires Further Screening)
- Aquifer - A

